

OrgaLED® Side Tunable White

DECO, POWER & HIGH POWER 24V DC

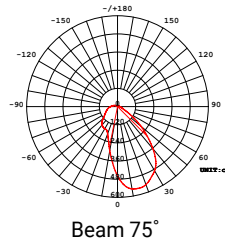

Project

Date

Accessories

OrgaLED strips offer a range of 'Plug & Play' IP40 and IP67 field installable connectors.

FEATURES

- Very Flexible (Bend radius >1.2"/30.5mm)
- High Efficacy- 95 lm/W
- 24V DC - Low Voltage, Class 2
- 33ft(10m) Continuous Runs
- 2700K-6500K
- Field Cuttable 3.94in (100mm)
- Dimmable, Dali, DMX
- UV/IR protected PVC encapsulation
- IP40 or IP67 Wet Location
- UL Listed / cUL Listed / CE /ROHS
- 5 years / 50,000 hrs warranty



Side Starter Cable
16ft (4.88m)
IP40 | IP67
#042502



Side Jumper Cable
8" (203.2mm)
IP40 | IP67
#042504



Side End Cap | IP40 / IP67
#042001



PVC IP67 Waterproofing Kit
#011511



IP67 Factory Waterproofing
#011508



Waterproof Mini J-Box
#PC-JBOX

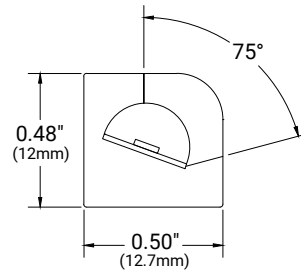
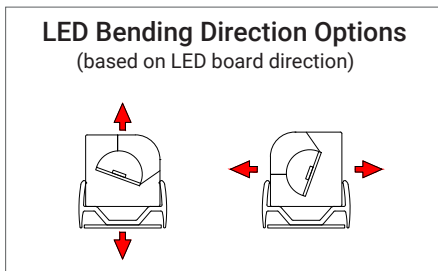

PART NUMBER & SPECIFICATIONS

Part #	Color	CRI	lm/ft	lm/m	Max Run	W/ft	W/m
OrgaLED® Deco Side - Tunable White							
042511	2700K-6500K	>95	244	800	33ft 10m	3	9.6
OrgaLED® Power Side - Tunable White							
042512	2700K-6500K	>95	372	1220	22ft 6.7m	4.4	14.4
OrgaLED® High Power Top - Tunable White							
042513	2700K-6500K	>95	556	1824	16ft 4.9m	5.9	19.2

Specifications may be modified or improved without notification

OrgaLED® Side Tunable White DECO, POWER & HIGH POWER



Power Supplies, Mountings & Extrusions

Project

Date

POWER SUPPLIES - 24V

Forward Phase, Reverse Phase, & 0-10V Dimming Drivers. Outdoor enclosures available.

Part #	Ingress	Voltage	Wattage	Dimensions (inches / mm)	Description
045001	IP67	100-305V	20W	7.6 x 1.18 x 0.79 / 193 x 30 x 20	Dimmable LED Driver
045002	IP67	100-305V	40W	5.83 x 1.58 x 0.87 / 148 x 40 x 22	Dimmable LED Driver
045003	IP67	120-277V	60W	6.3 x 2.24 x 1.5 / 160 x 57 x 38	Dimmable LED Driver
045004	IP67	120-277V	75W	6.3 x 2.24 x 1.5 / 160 x 57 x 38	Dimmable LED Driver
045005	IP67	120-277V	96W	7.6 x 2.24 x 1.5 / 193 x 57 x 38	Dimmable LED Driver
045006	IP67	120-277V	200W	10.1 x 3.03 x 1.8 / 257 x 77 x 46	Dimmable LED Driver
045007	IP67	120-277V	300W	11.9 x 3.03 x 1.8 / 302 x 77 x 46	Dimmable LED Driver

75W Dimmable Driver



ENCLOSURES

Part #	Ingress	Dimensions (inches / mm)	Description
045008	IP67	11.02 x 4.05 x 2.2 / 280 x 103 x 56	20W Enclosure
045009	IP67	11.02 x 4.05 x 2.2 / 280 x 103 x 56	40W Enclosure
045010	IP67	11.02 x 4.05 x 2.2 / 280 x 103 x 56	60W Enclosure
045011	IP67	11.02 x 4.05 x 2.2 / 280 x 103 x 56	75W Enclosure
045012	IP67	11.02 x 4.05 x 2.2 / 280 x 103 x 56	96W Enclosure
045013	IP67	16.7 x 9.8 x 2.3 / 424 x 249 x 58	200W Enclosure
045014	IP67	16.7 x 9.8 x 2.3 / 424 x 249 x 58	300W Enclosure

200W / 300W Enclosure

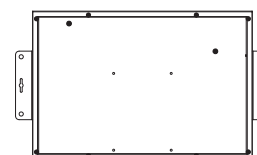

DMX CONTROLLER

Part #	Description
011343	100W Digital Controller
011344	180W Digital Controller
011345	720W Digital Controller
011341	Digital Controller & Power Supply Combination
011410	Nicolaude DE3 DMX 512 Controller
011403	Nicolaude DINA-DR1 DMX 512 Controller

Digital Controller (100W, 180W, 720W)



Nicolaude DE3 DMX 512 Controller



Mounting & Extrusions

Mounts directly with brackets, self adhesive transparent channels, or in aluminum extrusions. For more extrusions, visit organiclighting.com.



Aluminum Channel with an internal groove allows for a flathead screw. OrgaLED sits flush in channel.

Aluminum Channel
0.41" x 0.41" (10.4 x 10.4mm)
#012851
Aluminum Channel Clip
0.55" x 0.31" (14 x 7.9mm)
#012850



PVC Clear Channel is lightweight and self adhesive.

PVC Clear Channel 3.3ft (1m)
.57"W x .31"H (14.5 x 7.9mm)
#041007



SS Clip Side
0.97" x 0.75" x 0.51" (24.6 x 19.1 x 13mm)
#011373

Specifications may be modified or improved without notification



OrgaLED® Side Tunable White DECO, POWER & HIGH POWER

CABLE REQUIREMENT

The OrgaLED® LED strips need a minimum voltage at the beginning of the LED strip to function according to the specifications. The table below gives an indication of the maximum cable length based on the cable thickness. The standard OrgaLED® starter cable (20 AWG) has a cable length of 16ft(4.88m). In case the required length is longer than the length mentioned in this cable, it is recommended to cut the starter cable down to 1ft and splice a larger gauge cable. Please contact your distributor for a detailed cable calculation.

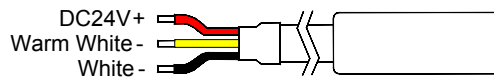

Cable X Information	LED Strip	Max. Cable Length
		24 V
20 AWG x 2	3.28 ft / 1m	303 ft / 92.35m
	16.4 ft / 5m	57 ft / 17.37m
	32.8 ft / 10m	36 ft / 10.98m
	49.2 ft / 15m	20 ft / 6.1m
	65.6 ft / 20m	16 ft / 4.9m
18 AWG x 2	3.28 ft / 1m	457 ft / 139.3m
	16.4 ft / 5m	86 ft / 26.21m
	32.8 ft / 10m	56 ft / 17.07m
	49.2 ft / 15m	35 ft / 10.67m
	65.6 ft / 20m	25 ft / 7.62m
16 AWG x 2	3.28 ft / 1m	914 ft / 278.6m
	16.4 ft / 5m	172 ft / 52.43m
	32.8 ft / 10m	90 ft / 27.43m
	49.2 ft / 15m	60 ft / 18.3m
	65.6 ft / 20m	40 ft / 12.2m
14 AWG x 2	3.28 ft / 1m	1521 ft / 463.6m
	16.4 ft / 5m	287 ft / 87.5m