

OrgaLED® Marker Lights

Project

Date



FEATURES

- 316 Outdoor Rated Stainless Steel Housing
- Drive-over Application - 3,000lbs
- Recessed Mounting
- Powered by OrgaLED's High Efficacy LEDs.
- 24V DC - Low Voltage, Class 2
- Remote Universal Voltage Driver (120-277V)
- 2700K, 3000K, 3500K, 4000K, 5000K, RGB, RGBW
- 3-in-1 Dimming, DMX 512, SPI
- Wet Location & Direct Buriable with waterproof connectors
- 50,000 hrs Lifetime



AVAILABLE SIZES

Marker Lights: 3" Circle

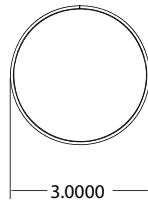
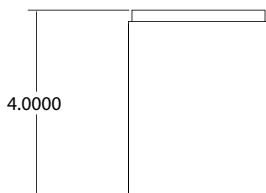

Marker Lights: 5.5" Circle

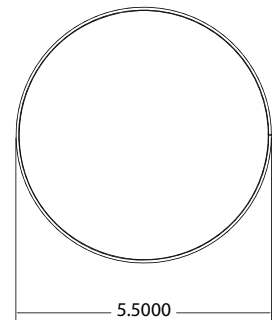
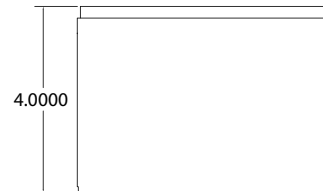

Marker Lights: 2.75" Square

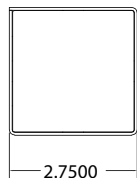
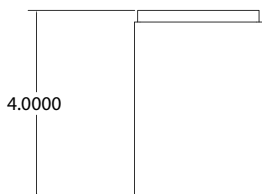

Marker Lights: 5" Square

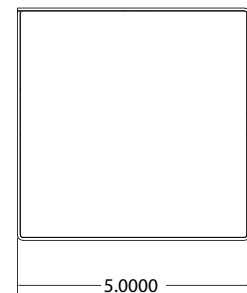
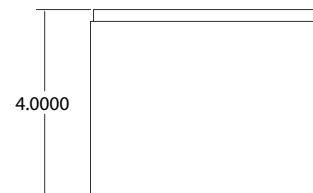

OrgaLED® Marker Lights

PART NUMBER & SPECIFICATIONS

Part #	Description	Wattage
OrgaLED® 3" Circle Marker Light		
015102	3" Circle Marker Light Housing - Wall Mount	
015103	3" Circle Marker Light Inground Housing	
015104	3" Circle Marker Light Dummy	
015127	3" Circle Marker Light - 2700K	1
015130	3" Circle Marker Light - 3000K	1
015135	3" Circle Marker Light - 3500K	1
015140	3" Circle Marker Light - 4000K	1
015150	3" Circle Marker Light - 5000K	1
0151RGB	3" Circle Marker Light - RGB	1.5
0151RGB-P	3" Circle Marker Light - RGB Pixel	1.5
0151RGBW	3" Circle Marker Light - RGBW	3
0151RGBW-P	3" Circle Marker Light - RGBW Pixel	3
OrgaLED® 5.5" Circle Marker Light		
015202	5.5" Circle Marker Light Housing - Wall Mount	
015203	5.5" Circle Marker Light Inground Housing	
015204	5.5" Circle Marker Light Dummy	
015227	5.5" Circle Marker Light - 2700K	2
015230	5.5" Circle Marker Light - 3000K	2
015235	5.5" Circle Marker Light - 3500K	2
015240	5.5" Circle Marker Light - 4000K	2
015250	5.5" Circle Marker Light - 5000K	2
0152RGB	5.5" Circle Marker Light - RGB	2.5
0152RGB-P	5.5" Circle Marker Light - RGB Pixel	2.5
0152RGBW	5.5" Circle Marker Light - RGBW	5.5
0152RGBW-P	5.5" Circle Marker Light - RGBW Pixel	5.5
OrgaLED® 2.75" Square Marker Light		
015302	2.75" Square Marker Light Housing - Wall Mount	
015303	2.75" Square Marker Light Inground Housing	
015304	2.75" Square Marker Light Dummy	
015327	2.75" Square Marker Light - 2700K	1
015330	2.75" Square Marker Light - 3000K	1
015335	2.75" Square Marker Light - 3500K	1
015340	2.75" Square Marker Light - 4000K	1
015350	2.75" Square Marker Light - 5000K	1
0153RGB	2.75" Square Marker Light - RGB	1.5
0153RGB-P	2.75" Square Marker Light - RGB Pixel	1.5
0153RGBW	2.75" Square Marker Light - RGBW	3
0153RGBW-P	2.75" Square Marker Light - RGBW Pixel	3
OrgaLED® 5" Square Marker Light		
015402	5" Square Marker Light Housing - Wall Mount	
015403	5" Square Marker Light Inground Housing	
015404	5" Square Marker Light Dummy	
015427	5" Square Marker Light - 2700K	2
015430	5" Square Marker Light - 3000K	2
015435	5" Square Marker Light - 3500K	2
015440	5" Square Marker Light - 4000K	2
015450	5" Square Marker Light - 5000K	2
0154RGB	5" Square Marker Light - RGB	2.5
0154RGB-P	5" Square Marker Light - RGB Pixel	2.5
0154RGBW	5" Square Marker Light - RGBW	6
0154RGBW-P	5" Square Marker Light - RGBW Pixel	6

Project

Date



Circle Marker Light Housing



3" Circle Marker Light



5.5" Circle Marker Light



2.75" Square Marker Light



5" Square Marker Light

Specifications may be modified or improved without notification

OrgaLED® Marker Lights

POWER SUPPLIES - 24V

Forward Phase, Reverse Phase, & 0-10V Dimming Drivers. Outdoor enclosures available.

Part #	Ingress	Voltage	Wattage	Dimensions (inches / mm)	Description
045001	IP67	100-305V	20W	7.6 x 1.18 x 0.79 / 193 x 30 x 20	Dimmable LED Driver
045002	IP67	100-305V	40W	5.83 x 1.58 x 0.87 / 148 x 40 x 22	Dimmable LED Driver
045003	IP67	120-277V	60W	6.3 x 2.24 x 1.5 / 160 x 57 x 38	Dimmable LED Driver
045004	IP67	120-277V	75W	6.3 x 2.24 x 1.5 / 160 x 57 x 38	Dimmable LED Driver
045005	IP67	120-277V	96W	7.6 x 2.24 x 1.5 / 193 x 57 x 38	Dimmable LED Driver
045006	IP67	120-277V	200W	10.1 x 3.03 x 1.8 / 257 x 77 x 46	Dimmable LED Driver
045007	IP67	120-277V	300W	11.9 x 3.03 x 1.8 / 302 x 77 x 46	Dimmable LED Driver

Project

Date

ENCLOSURES

Part #	Ingress	Dimensions (inches / mm)	Description
045008	IP67	9.4 x 2.6 x 1.9 / 239 x 66 x 48	20W Enclosure
045009	IP67	11.02 x 4.05 x 2.2 / 280 x 103 x 56	40W Enclosure
045010	IP67	11.02 x 4.05 x 2.2 / 280 x 103 x 56	60W Enclosure
045011	IP67	11.02 x 4.05 x 2.2 / 280 x 103 x 56	75W Enclosure
045012	IP67	11.02 x 4.05 x 2.2 / 280 x 103 x 56	96W Enclosure
045013	IP67	16.7 x 9.8 x 2.3 / 424 x 249 x 58	200W Enclosure
045014	IP67	16.7 x 9.8 x 2.3 / 424 x 249 x 58	300W Enclosure

CONTROLLERS

Part #	Description
011343	100W Digital Controller
011344	180W Digital Controller
011345	720W Digital Controller
011341	Digital Controller & Power Supply Combination
011420	Nicolaude DE3 DMX 512 Controller
011403	Nicolaude DINA-DR1 DMX 512 Controller
050203	LT-200 SPI Controller - For Pixel
050205	DMX512 SPI Converter Decoder - For Pixel

ACCESSORIES

Part #	Description
015011	18 gauge 2 wire cable - direct burial
015012	16 gauge 2 wire cable - direct burial
015013	16 gauge 4 wire cable - direct burial
015015	16 gauge 5 wire cable - direct burial
015090	3M Scotchlok UL Connectors

CONNECTION

Splice connection using Scotchlok® connectors.

Turn power off before installing or removing terminal. All electrical work should be done according to appropriate electrical codes.

1. Insert 2 or 3 unstripped wires completely into the connector and check their position by looking through the translucent connector body.
2. Hold the tool perpendicular to the wires and make the connection by driving the cap down flush with the top edge of the connector body.

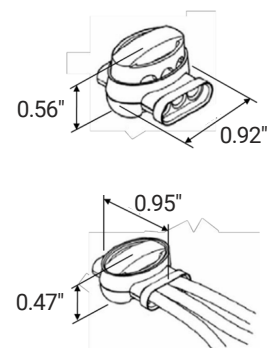

Specifications may be modified or improved without notification