

# OrgaLED® Standard Mounting

## PET CHANNEL



- PET channel with self adhesive. Internal grooves allow for screw use.
- 39" length, field cuttable
- Available in Clear or White

## PVC CLEAR CHANNEL



- PVC clear channel Internal grooves allow for screw use.
- 4ft length, field cuttable
- Available in Clear

## ALUMINUM CHANNEL & CLIP

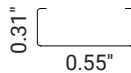
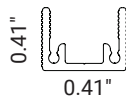

- Internal grooves allow for screw use.
- 39" length, field cuttable.
- Clip available for easy installation and/or removal, sold separately.

## STAINLESS STEEL CLIP

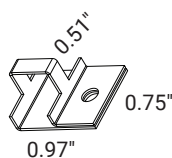
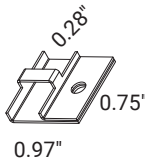

- OrgaLED® Top or Side compatible.
- 316 SS - Exterior Rated.
- Clip wraps around the OrgaLED® strip for a secure fit.
- 16"-18" spacing recommended.

## ORGAGLIDE 1™ CHANNEL

PATENT PENDING

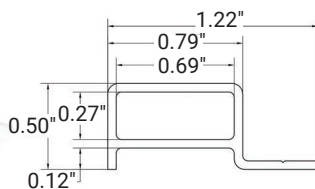

- OrgaLED® Top only.
- Surface, wall, floor, recessed mounting.
- Pre-installed self adhesive. Internal grooves allow for screw use.
- Easy alignment for continuous runs.
- Quick Installation.
- 96" length, field cuttable.

## PART NUMBERS & SPECIFICATIONS

Part #	Description
011368	PET White Mounting Channel, L39", 0.5"W
011369	PET Clear Mounting Channel, L39", 0.5"W
012851	Aluminum Mounting Channel, L39", 0.5"W (clip not included)
012850	Clip for Aluminum Mounting Channel
011378	Stainless Steel Top Clip
011373	Stainless Steel Side Clip
012957	OrgaGlide 1 Channel
041007	PVC Clear Channel 4FT

Project
Date

## COMPATIBILITY

All Standard Mounting options are compatible with OrgaLED®.

OrgaLED® Diffuse is compatible with the Standard Mounting options except the Stainless Steel Clips.